

Wetting Your Beds

John Geib

Master Gardener

Compost Specialist

Vegetable Specialist



Improving Lives. Improving Texas.



Overview

- **Why we need to water**
- **Where will we get the water**
- **What are we trying to water**
- **How to Water**
- **Drip Tips**

Yes We Live in a Desert





Where are you getting your Water

- **City**
- **Well**
- **Rain Water Collection**
- **Mother Nature**

What are you Watering



What are you Watering



What are you Watering



What are you Watering



What are you Watering



What are you Watering



What are you Watering



What are you Watering



What are you Watering



What are you Watering



What are you Watering



What are you Watering



What are you Watering





What are you Watering

- **Lawn**
- **Trees**
- **Flower Beds**
- **Water Feature**
- **Vegetable Gardens**



How MUCH to Water your Lawn

- **Type of Grass**
- **Weather**
- **Sun / Shade**
- **Usually 1" per week is good**

How MUCH to Water your Lawn

- **Typical lot = 65' x 125', 0.20 acres or 8,300 ft²**
 - 1,800 ft² house,
 - 500 ft² garage,
 - 20'x30' drive,
 - 400 ft² of other non-landscape area
- **4,800 ft² of landscape to water**
- **Usually 1" per week**
- **12,000 gallons of water per month**



How to Water your Lawn

- **Sprinkler**
 - Manual
 - Rotary
 - Pop up
- **Hand**
- **Drip**



How to Water your Lawn



How to Water your Lawn





How to much DID your Water Lawn

- **Can estimate based on sprinkler head flow rates**
- **Tuna can**

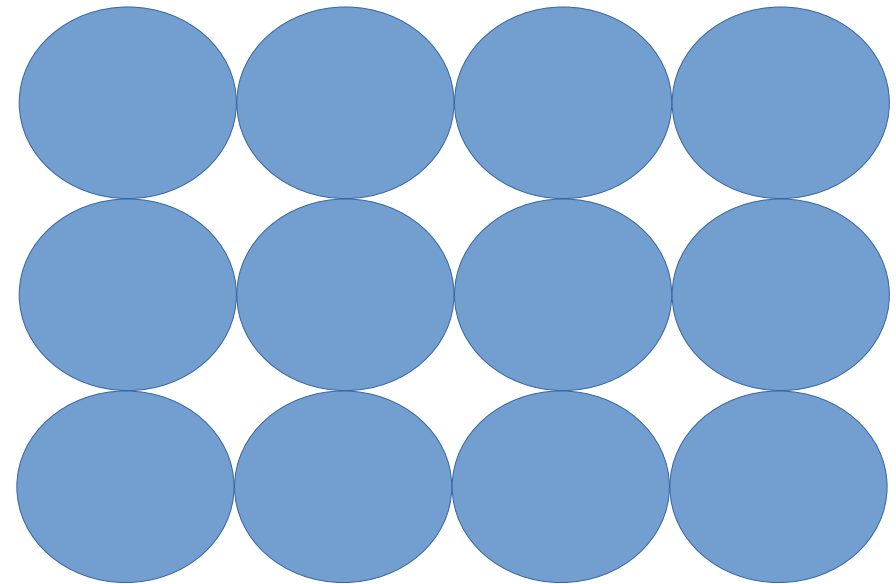
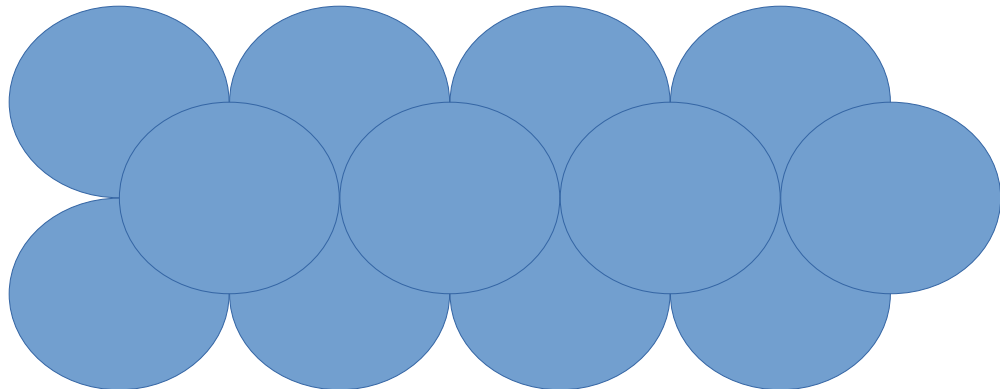

How much DID you water your Lawn



How much DID you water your Lawn





When to Water your Lawn

- **Early Morning**
- **Evening**
- **Once per week**



Watering your Trees

- **Based on tree varieties**
- **Same basic rules as for Lawn**
 - **Early morning/late evening**
 - **Drip/hand/rotary sprinkler**
 - **Usually about 1"/week**
- **Drip Line**

Watering your Trees

- **Water at the Drip Line**

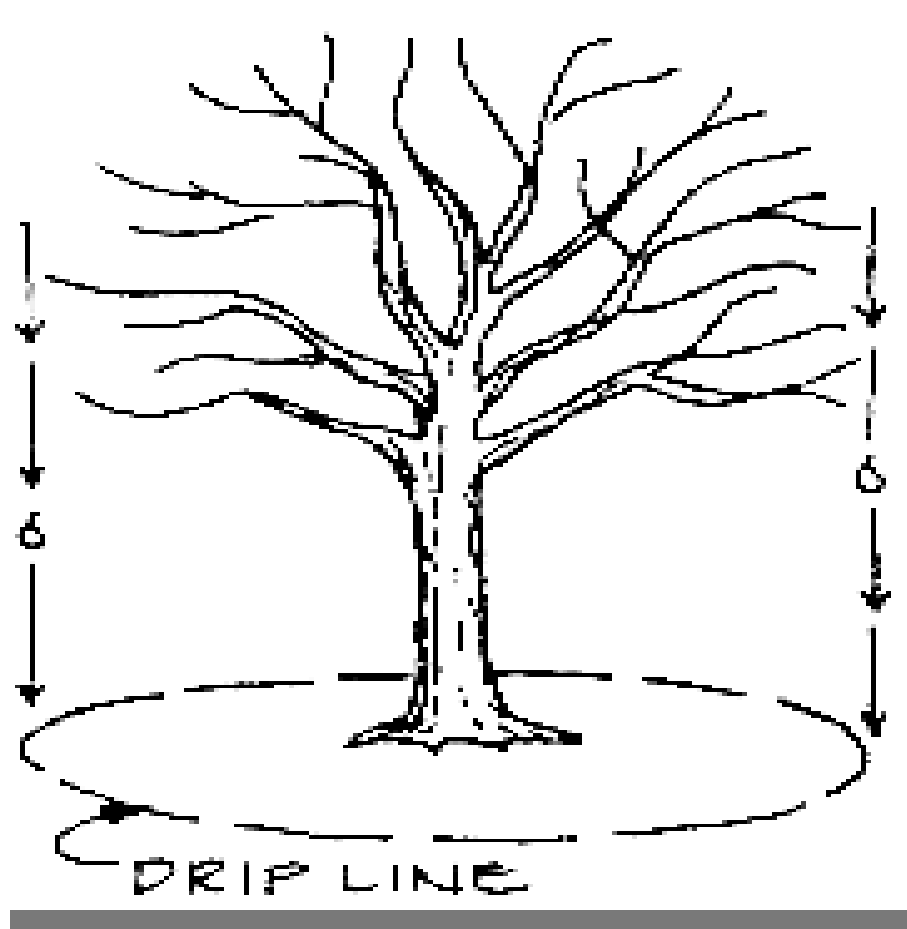



Watering your Flower Beds

- **Based on plant varieties**
- **Same basic rules as for Lawn**
 - **Early morning/late evening**
 - **Drip/hand/rotary sprinkler**
 - **Usually about 1"/week**

Watering your Flower Beds



Watering your Water Features

- Usually best to do by hand or float system



Watering your Water Features

- **Try and shade the water to reduce evaporation**





Watering your Veggies

- Drip or Hand Watering
- Rule of Thumb 1 inch per week
- Total water needed from rainfall + irrigation



Seasonal Water Requirements

Cabbage	14 – 17
Cantaloupe	16 – 20
Carrot	12 – 16
Sweet corn	20 – 24
Onion	22 – 25
Pepper	25 – 30
Potato	20 – 25
Spinach	10 – 15
Tomato	22 – 26
Watermelon	10 – 15

Draw your Plan

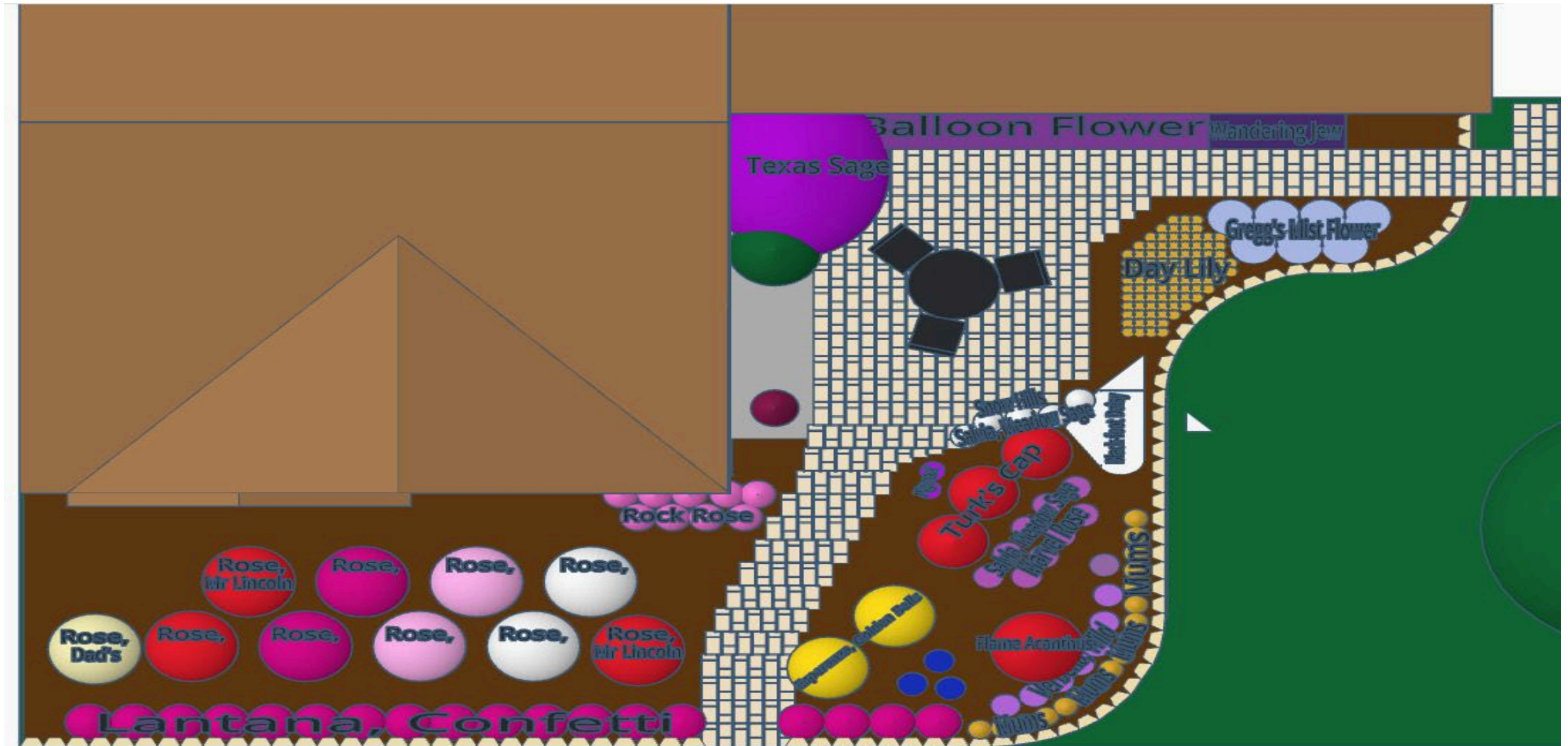

Draw your Plan

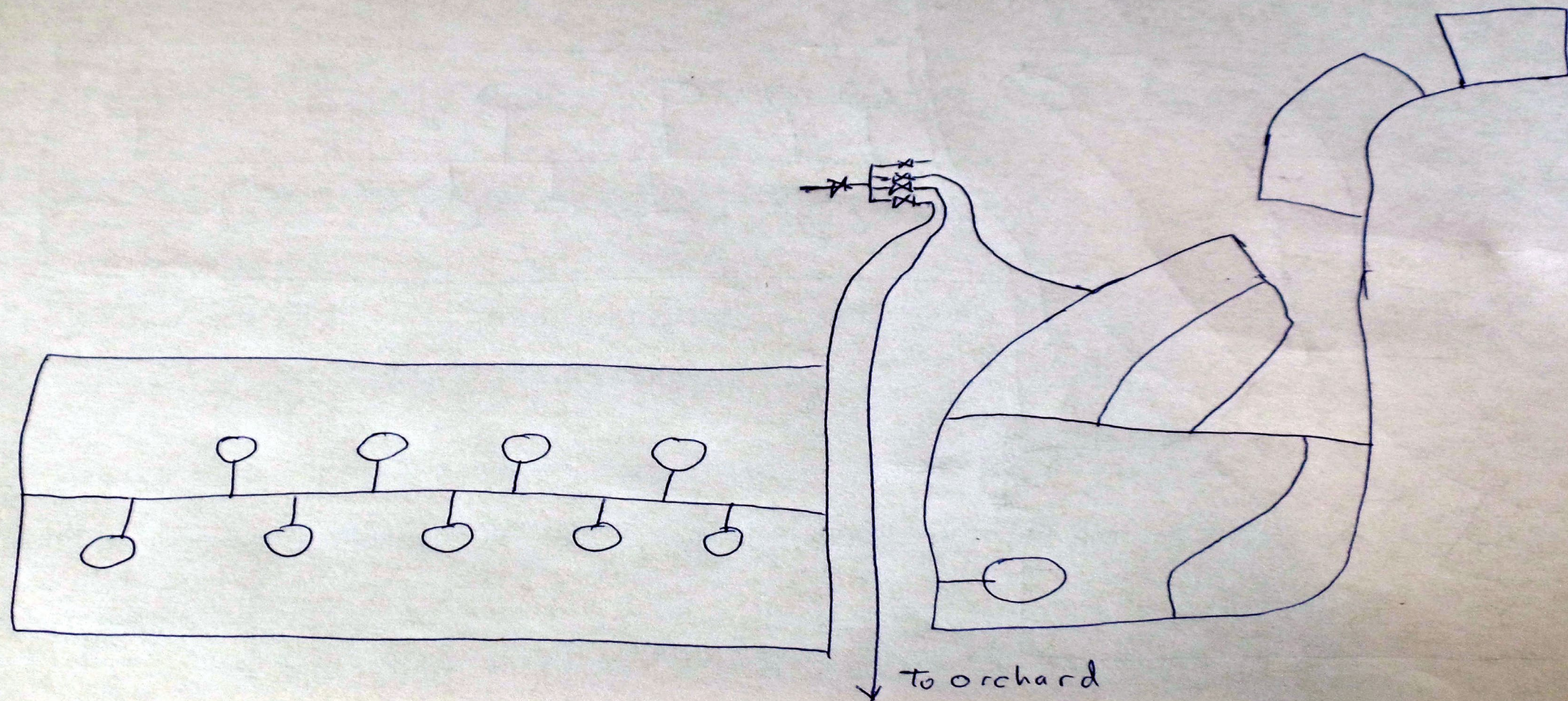

Draw your Plan

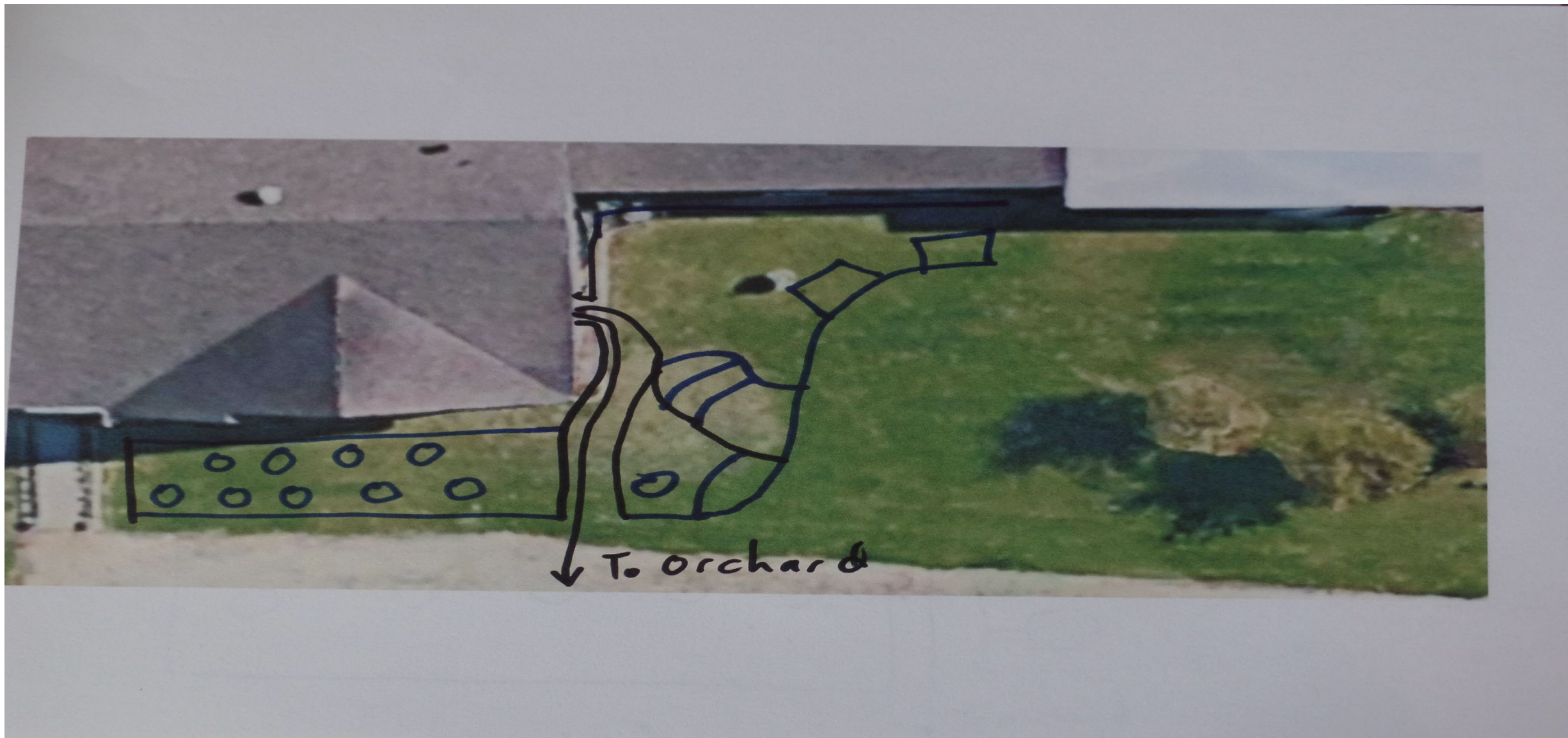

Draw your Plan

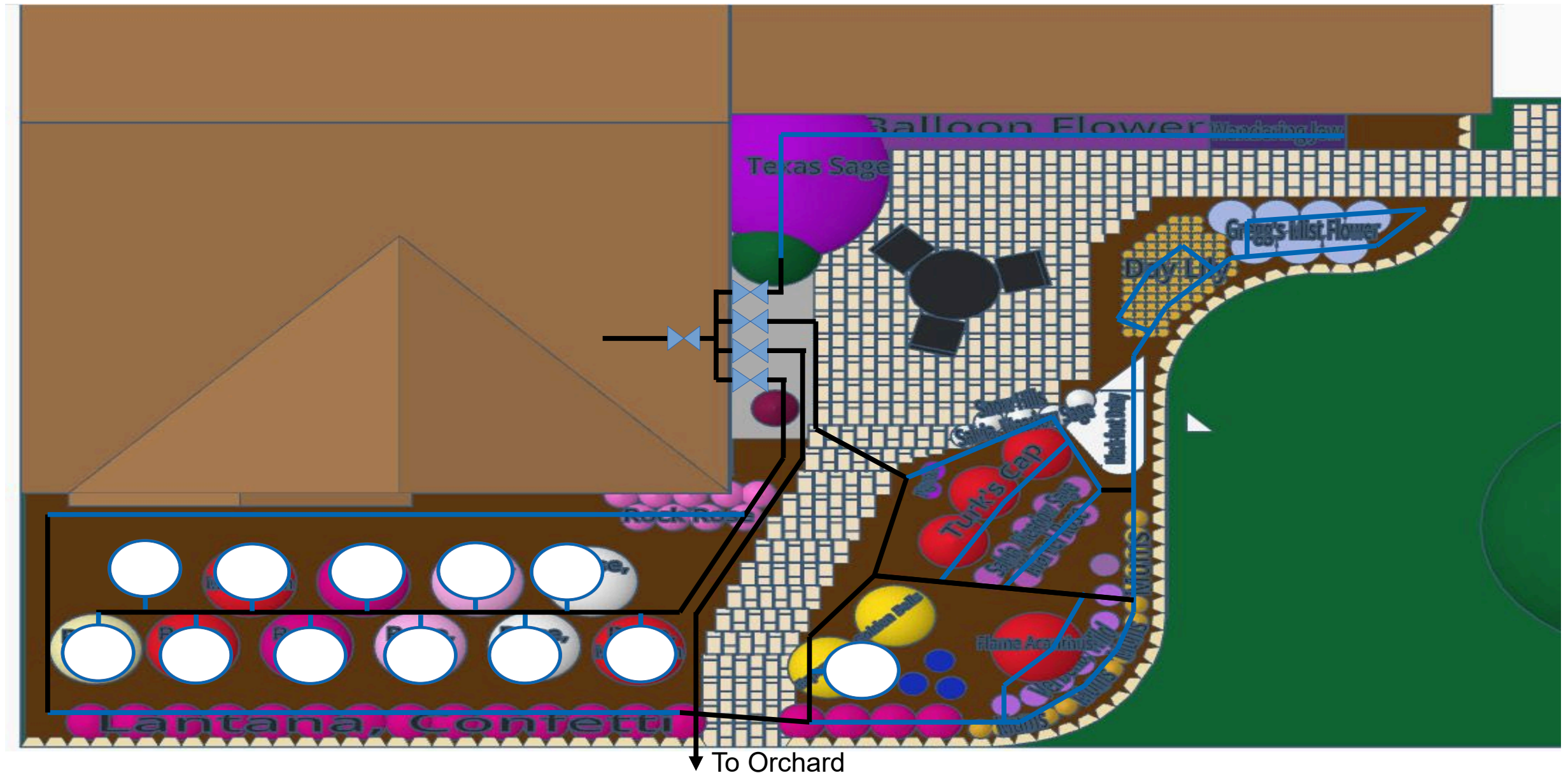



Draw your Plan

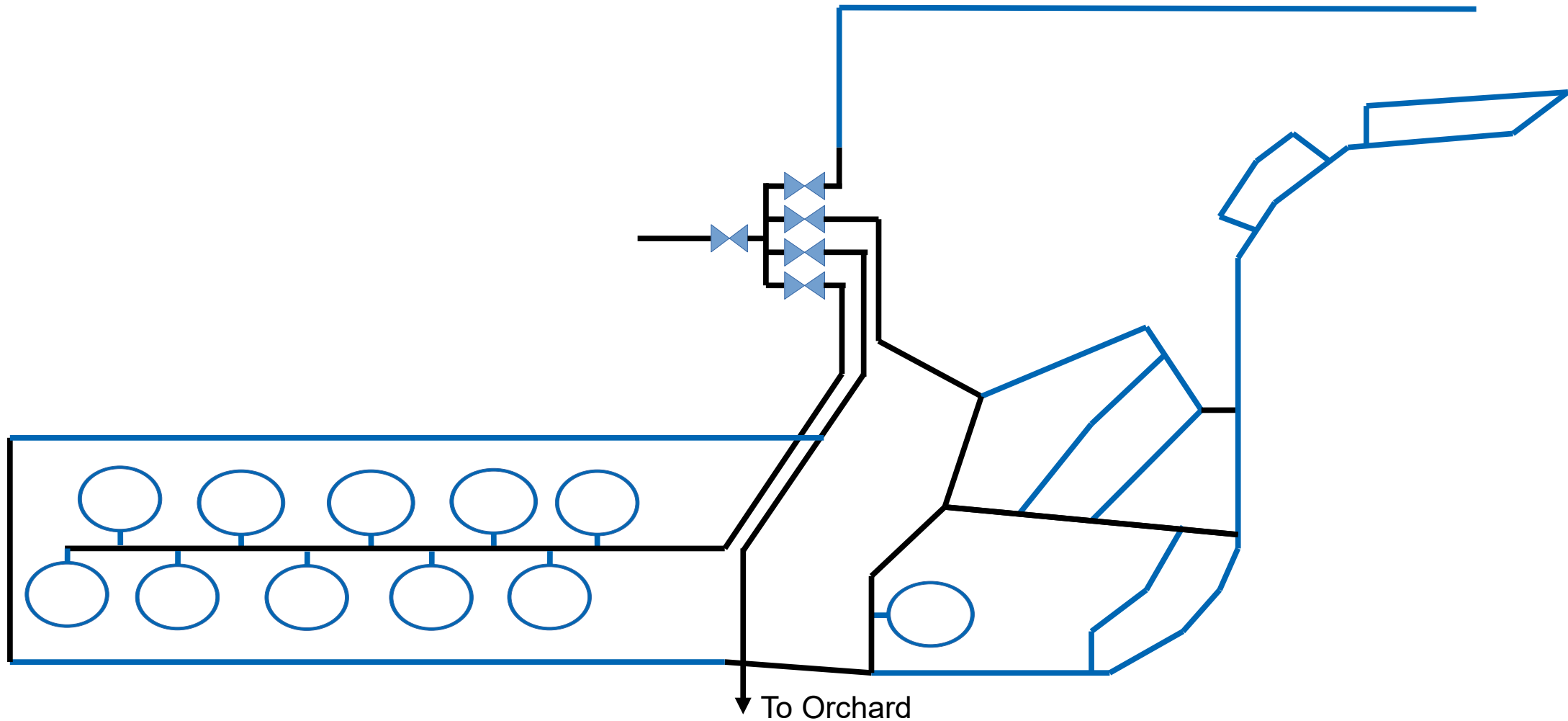



Drip Irrigation

- **Do NOT use stuff from big box stores**
- **Go to an irrigation supply store**



Drip Irrigation

- **Can be connected to existing irrigation systems**
- **Cannot mix pop-up and drip on same circuit**
- **Need pressure regulated to 20 psi**



Drip Irrigation Parts



Drip Irrigation Parts



Drip Irrigation Parts

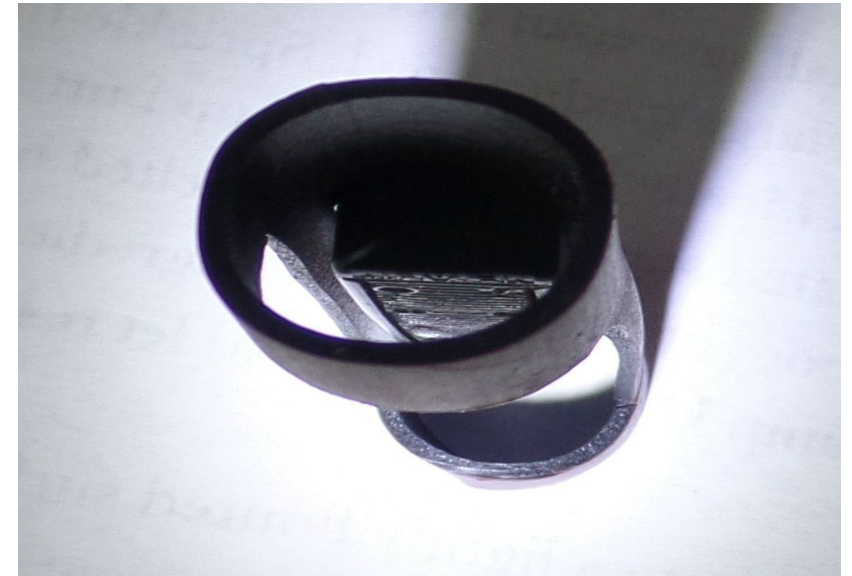
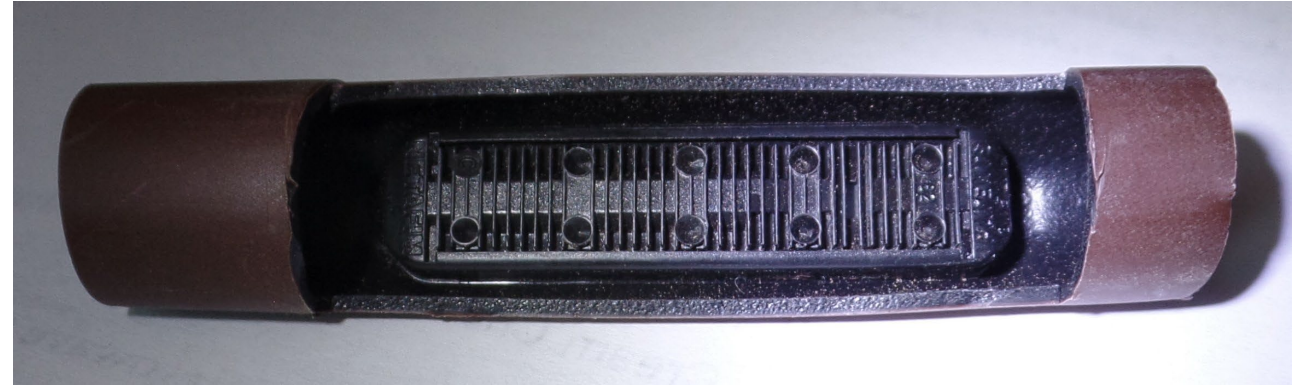
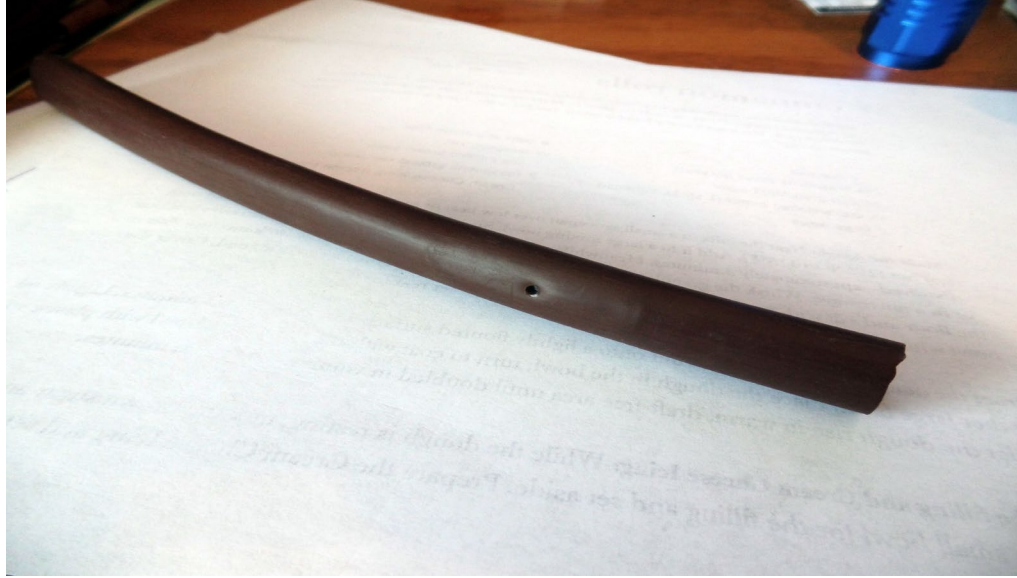

Drip Tips





Flower Beds





Flower Beds





Flower in Containers





Flower in Containers

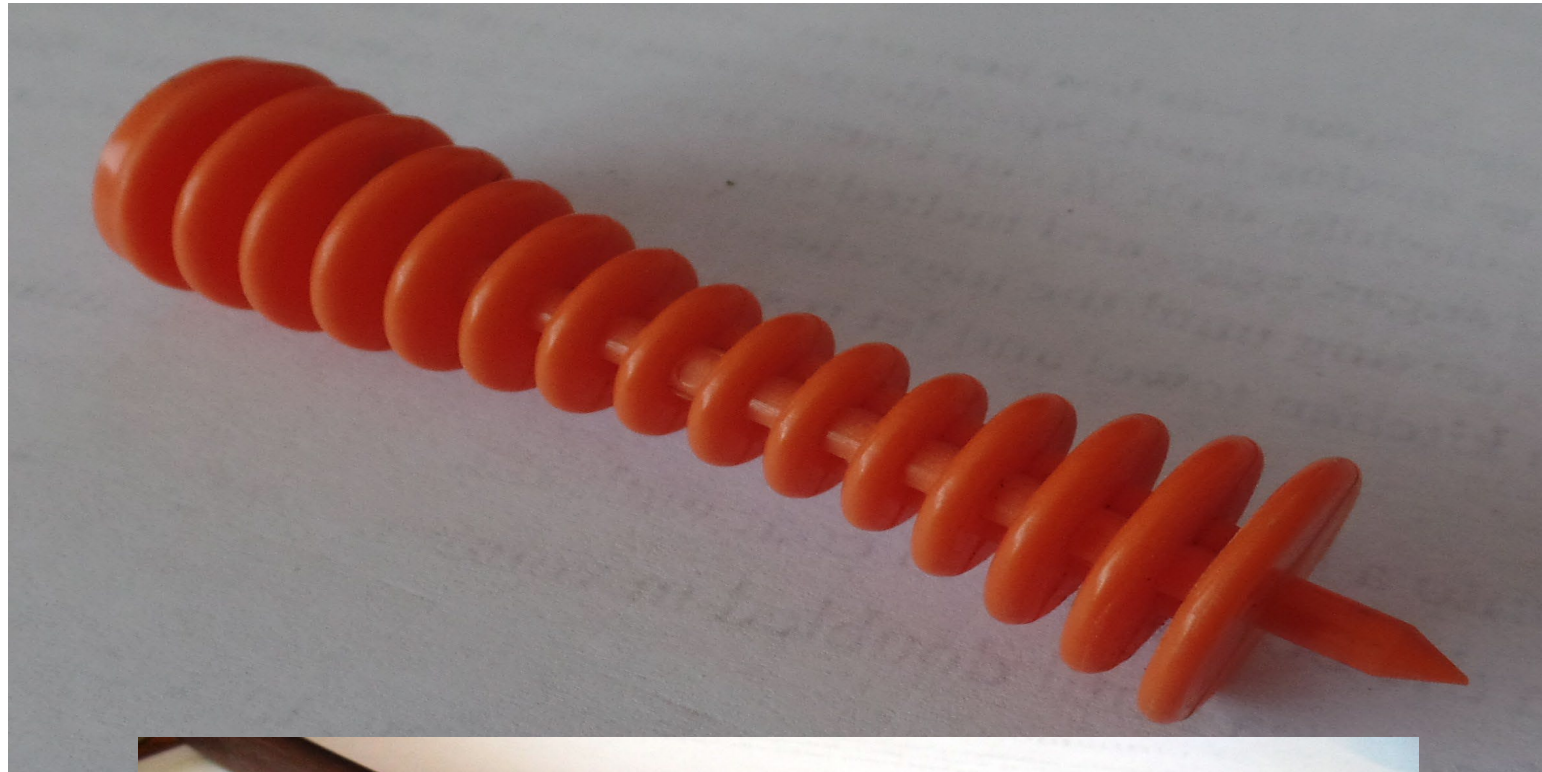



Flower in Containers

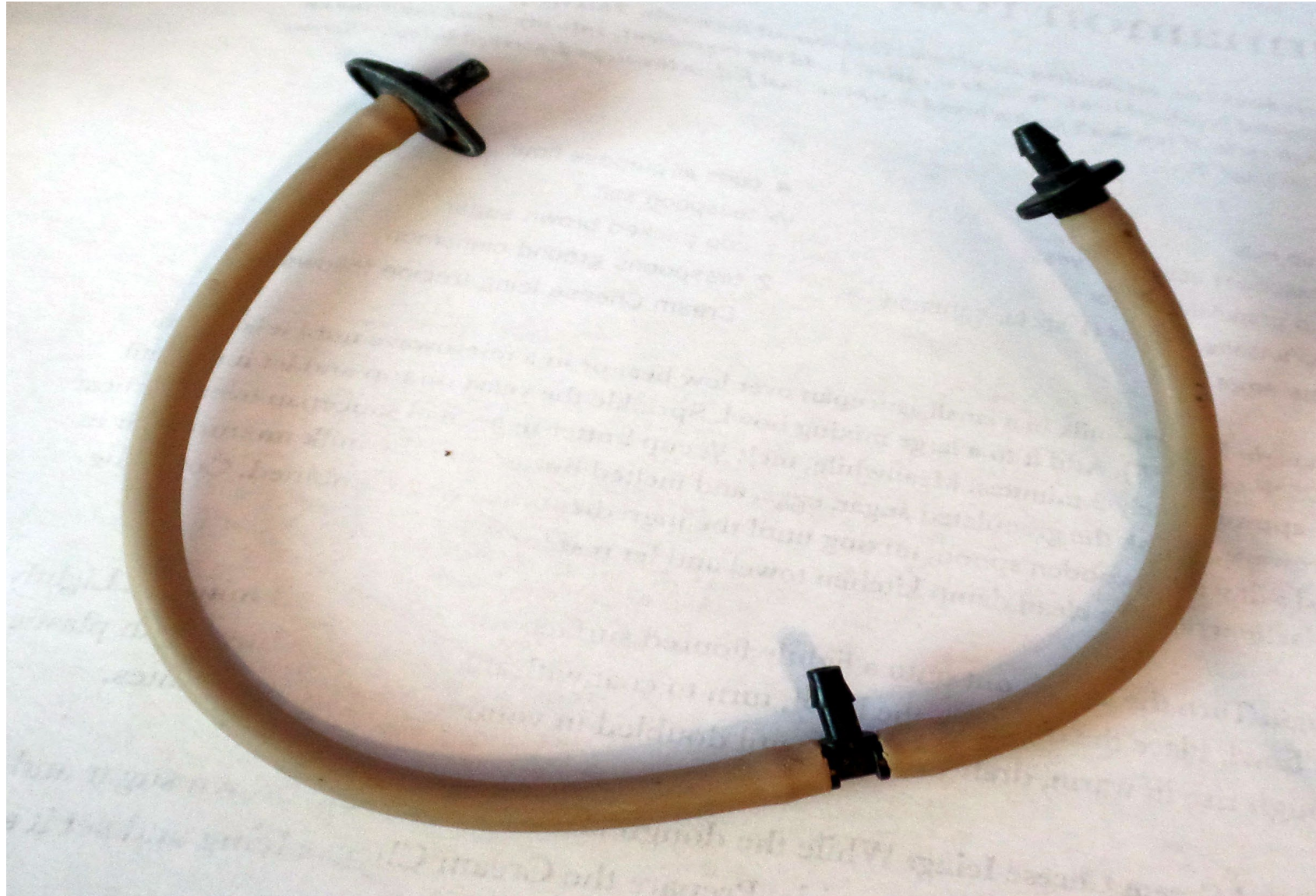



Vegetable Beds



QUESTIONS?

www.bcmgtx.org

Big Country Master Gardeners on Facebook
Big Country Master Gardeners on YouTube



Texas A&M AgriLife Extension Service is an equal opportunity employer and program provider. The Texas A&M University System, U.S. Department of Agriculture, and the County Commissioners Courts of Texas Cooperating.